

CRAPPIE

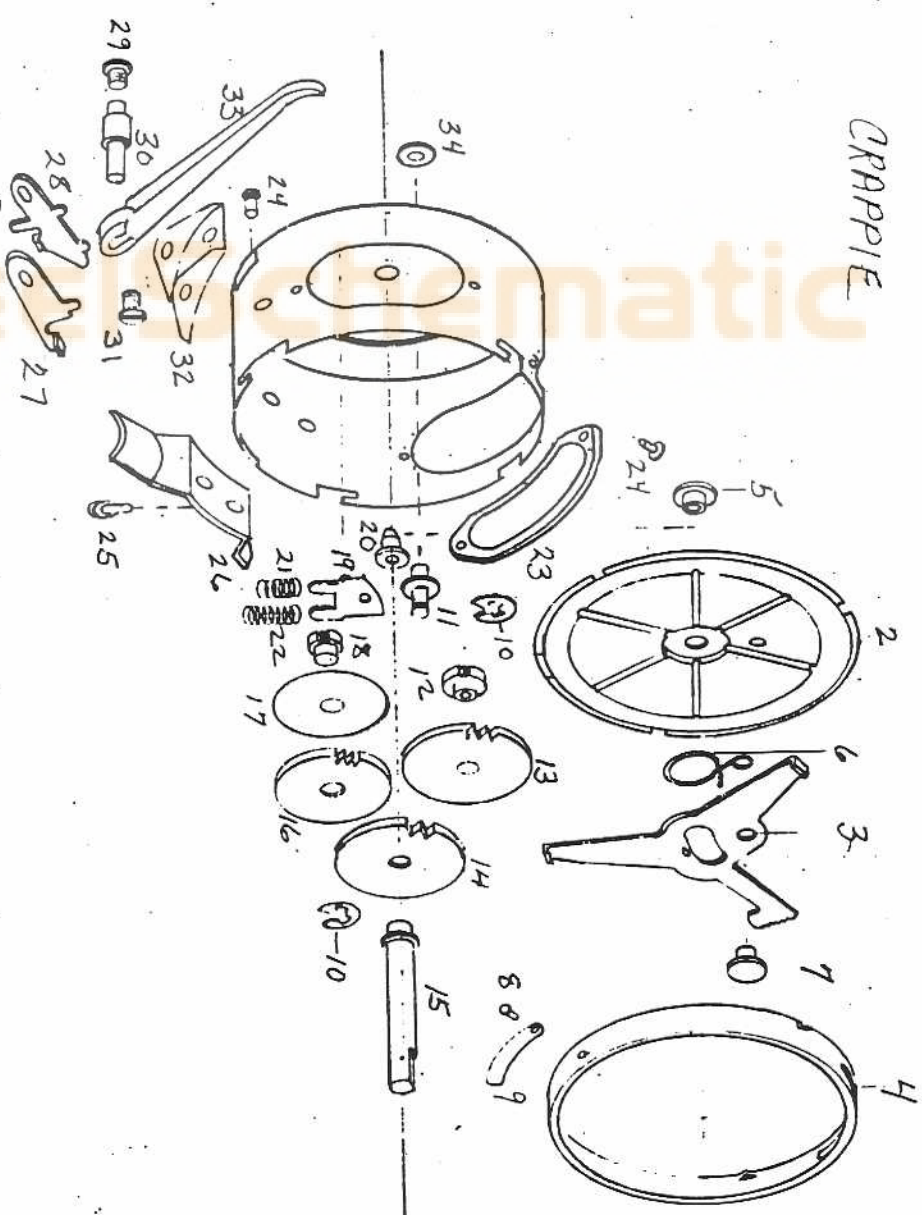

PART NUMBER	QUANTITY	PART NUMBER	QUANTITY
1 S-1-CRAPPIE BODY (BLK)	1	19 S-3 PHYL RELEASE HANDLE	1
2 75 INSIDE WASH	1	20 S-4 BACK BUSHING	1
3 73 LOCK LEVER	1	21 52 RATCHET PAWL SPRING	1
4 76 RIM	1	22 51 RELEASE SPRING	1
5 27-AN BUSHING	1	23 23-38/48 LINE GUIDE (D)	1
6 71 LOCK LEVER SPRING	1	24 23-RIVET	3
7 71 LOCK LEVER STUD	1	25 S-3 RIVET	4
8 54 WIP RIVET	1	26 785 REEL FOOT	1
9 42-F RIM LOCK SPRING	1	27 50 RATCHET PAWL	1
10 347 GEAR AND PINION	2	28 49 RELEASE PAWL	1
11 179 GEAR STUD	2	29 55-S SCREW	1
12 S-9 PINION GEAR	1	30 43-48 BRK SHFT	1
13 S-10A S SECONDARY GEAR	1	31 56-S SCREW	1
14 S-10 S STAINLESS GEAR	1	32 44-F U LEVER BRACKET (D)	1
15 S-12-3 SPINDLE	1	33 57 BRK LEVER BRACKET (D)	1
16 S-12 RATCHET GEAR	1	34 S-40 MOUNTING WASHER	2
17 S-12 PINION SPRING	1	35	
18 S-8 CRAPPIE PINION	1		

D = CHROME
 S = STAINLESS STL.